

# DUO29

Aluminium ladder

ISO DIN 4113 and TÜV certified.

Made of 50mm aluminium alloy (EN AW 6082 T6, diameter 50 mm, thickness 2 mm) .

Use the conical connectors for nomad and permanent installations.

The perfect equipment for expositions, banners, advertisements, or stage design.

- Width 290 mm.
- Tube diametre: 50 mm, thread: 16 mm.

This structure is supplied with :

- 1 x Connection kit per truss
- 1 x Connection kit per 2-direction angle
- 2 x connection kit per 3 and 4-direction angles



154

## DUO29-029

ref 10036

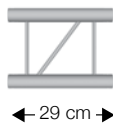

## DUO29-050

ref 10037

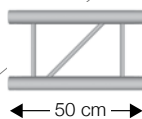

## DUO29-100

ref 10038

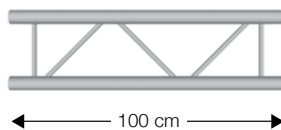

## DUO29-200

ref 10039

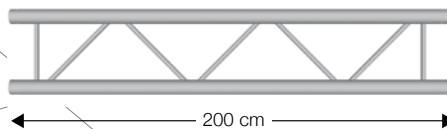

## DUO29-300

ref 10040

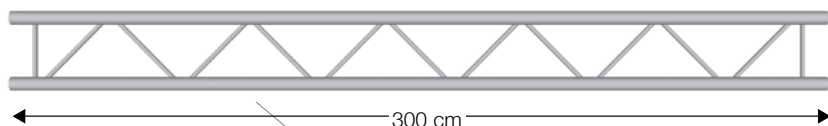





LENGTH (M)		1	2	3	4	5	6
Max load (center) (kg)		694	272	142	72	43	23
Distortion (mm)		1	2	3	3	3	3
Max distributed load (kg/m)		694	251	94	36	17	7
Distortion (mm)		1	2	3	4	5	6

Table loads indicate the maximum load-bearing capacity between two fixation points. Centered and distributed loads cannot be cumulated. Talk to a qualified engineer for more information