

NEXT
audiocom

MODUS₂

PORTABLE SOUNDBAR

USER MANUAL

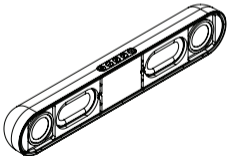

EN

INTRODUCTION

INTRODUCTION

Thank you for purchasing a NEXT Audiocom MODUS 2 Portable BT Soundbar. Fully charge the speaker before using it for the first time.

This user manual will provide you with useful and important information about your equipment. Please devote some time reading it and keep it at hand for future reference.

ATTENTION! For the most updated version of this manual and general information about this and other products, please visit our website www.nextaudiogroup.com.

FEATURES

- Beautiful simplistic design to blend perfectly with almost any decor
- Powerful sound
- Multiple playback options
- Built-in Mic for hands free phone calls
- Remote control
- Built-in rechargeable battery

UNPACKING

All products from NEXT Audiocom are built under strict quality guidelines and supervision, according to the highest standards. Inform your dealer if any issue is found.

INTRODUCTION

PACKAGING CONTENTS

- NEXT Audiocom MODUS 2
- Remote Control
- USB Cable
- User Manual



SAFETY FIRST

- Read these instructions carefully.
- Keep all information and instructions in a safe easy to access place.
- Follow all instructions and heed all warnings.
- Use the equipment only for its intended purpose as instructed in this manual.
- Never use your MODUS 2 close to ignition or heat sources such as radiators, ovens or other.
- Do not use the equipment near water sources or exposed to rain.
- Place the equipment on a stable surface and out of the reach of children.
- If the equipment is not functioning properly or has been damaged in any way, switch it off immediately.
- Do not open or try to service the equipment. It may only be repaired by authorized, qualified personnel.
- Clean the equipment using only a clean dry cloth.
- Do not operate the unit for an extended period with the sound distorting.

MODUS 2 OVERVIEW

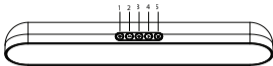

1. Power On/Off

Press and hold. If the MODUS 2 is left idle and unpaired, it will automatically turn off after a few minutes.

2. Decrease Volume

Any: Short press to decrease volume.

USB/SD: Long press to play the previous song.

FM Tuner: Long press to switch to the previous station.

3. Increase Volume

Any: Short press to increase volume.

USB/SD: Long press to play the next song.

FM Tuner: Long press to switch to the next station.

4. Play

USB/SD/BT: Press to play or pause.

FM Tuner/AUX: Press to mute or unmute. Long press to scan for FM channels automatically.

Phone Call: Short press to answer, or end conversation. Long press to reject.

5. Reproduction Mode

Press to switch between USB, TF Card, AUX, FM Radio and BT. Long press to disconnect existing BT connection and search a new connection.

MODUS 2 OVERVIEW

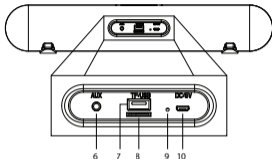

6. Auxiliary Input

3.5mm TRS (Jack) plug.

7. USB Plug

Insert a USB Stick with .MP3 or .WAV audio files.

8. Micro SD Slot

Insert a Micro SD card with .MP3 or .WAV audio files.

9. Charging Signal LED

Lights Red when charging.

10. 5V DC Charger Input and FM Antenna Input

Connect to a 5V/1A charger. The charger cable also doubles as FM antenna.

REMOTE CONTROL

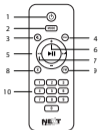

1. Off Button

Turn Off the MODUS 2 (can't turn on)

2. Mode

Press to switch between modes of operation

3. Mute

Press to mute or unmute

4. Scan

Press to automatically scan for radio channels when in FM mode.

5. Volume +/-

Press "+" to increase volume and "-" to decrease volume

6. Play/Pause

Press to play or pause when in the USB, SD, or BT mode

7. Previous/Next

Press to change track or FM channel

8. BT

Change to BT Mode

9. FM

Change to FM receiver mode

10. Numeric Keypad

Select the track in USB or SD card mode or the FM channel on FM mode.

CONNECTIONS

CHARGING

Please use a good quality 5V/1A charger to charge the MODUS 2 (not included). Use only the supplied cable or a compatible micro USB cable. Do not try to charge the MODUS 2 through the USB type A plug. The red LED glowing indicates that the battery is charging. Once charged completely the LED is turned off. The MODUS 2 can function while charging though the charging time will increase. Do not attempt to charge MODUS 2 using the USB type A plug.

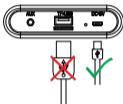

AUDIO AUX INPUT

The MODUS 2 is equipped with a 3.5mm stereo TRS plug to enable the user to enjoy music from devices that do not have BT capability.

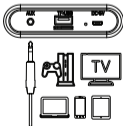

CONNECTIONS

WIRELESS BT

PAIRING

Enable BT on your device and enable the BT mode on the MODUS 2. On your device search and connect to "NEXT MODUS 2" on the available devices list. The MODUS 2 will "speak" when the connection is successful. The MODUS 2 and your device will "remember" each other and automatically connect if BT is enabled on both devices and in range. If you want to connect to a different device, you'll need to terminate the current connection and repeat the process on the other device. Refer to your device's user manual for more details if needed.

RECEIVING CALLS

The MODUS 2 will work as a "Hands Free" device if your smartphone is configured to allow this. By default, this will be the case on most devices. If not, refer to your smartphone's user manual for instructions on how to enable or disable this.

Once an incoming call is received:

- Press Play/Pause to answer.
- After answering, press Play/Pause again to terminate.
- Long press the Play/Pause button to reject call.

CONNECTIONS

FM RADIO

The MODUS 2 features also an FM radio receiver. Use the mode button to switch to FM mode. To scan for available radio stations, connect your charging cable or a cable featuring a 3.5mm TRS plug to "AUX" input to serve as an antenna. Then long press the Play/Pause button on the MODUS 2 or press the scan button on the remote. The MODUS 2 will automatically scan and save all the available radio stations and save them in sequence. When this process is completed, press the Previous/Next button to cycle between all the available radio stations memorized. You can select the memorized station position by typing its number on the remote and wait about 2 seconds (press 01 for the first position, 02 for the second etc.).

TECHNICAL SPECIFICATIONS

BT Version - v5.0

BT Range - 10m

Power Output - 20W (2x10W)

**Drivers - 2 x 2" Full-Range Driver,
2 x Passive Radiators (Subwoofer)**

Frequency Response - 100Hz - 20.000Hz

Battery Capacity - 4000mAh

Playback Time - 4 to 6 Hours

Charging Time - 3 to 4 Hours

Dimensions (WxHxD) - 42cm x 7.3cm x 6.5cm

Weight - 900g



 Rua da Venda Nova, 295 | 4435-469 Rio Tinto, Portugal

 info@nextaudiocom.com

 www.nextaudiocom.com

 [instagram.com/next.audiocom](https://www.instagram.com/next.audiocom)

 [facebook.com/nextaudiocom](https://www.facebook.com/nextaudiocom)